



## JTGK-500C Specular Chamfering CNC Machine

### Product descriptions and features

#### ■ Features

- Specular effect can be realized on workpiece surface
- High speed, high precision
- Level chip filtration system

#### ■ For Material

Aluminum alloy, acrylic, copper, stainless steel

#### ■ Applied Range

Specular chamfering on the housing of electronic products, mold making



KEJIE website



KEJIE wechat

## Parameters

Item	Parameter
Working area X/Y/Z	500/400/230mm
Work table size	500x400mm
Max load of table	150kg
Spindle power Max spindle speed	4.0kw/30000rpm
Rapid traverse rate	12m/min
Cutting feed rate	10m/min
Positioning accuracy	0.008mm
Repeatability	0.004mm
Weight	3000kg
Machine dimension	1750x1800x2300mm
Power supply	3-PH AC380V ±5% 50Hz

## Standard Accessories

- High speed CNC controller
- High speed spindle
- AC servo motor
- Precision ball screw and guide rail
- Tool setting sensor
- Hand Wheel
- Spindle cooling system
- Automatic tool changer

## Optional Accessories

- 4th axis
- Voltage stabilizer
- Oil mist collector
- Probe
- Ultra-precision filtration system

# Machine dimension

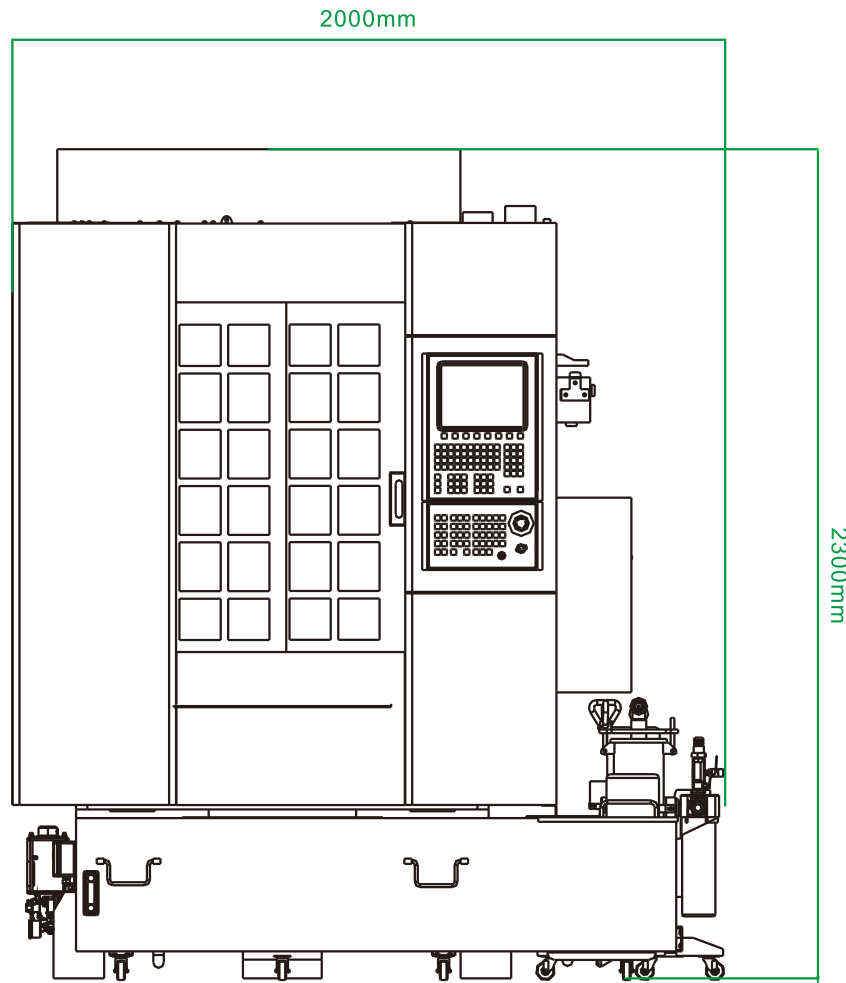

Front

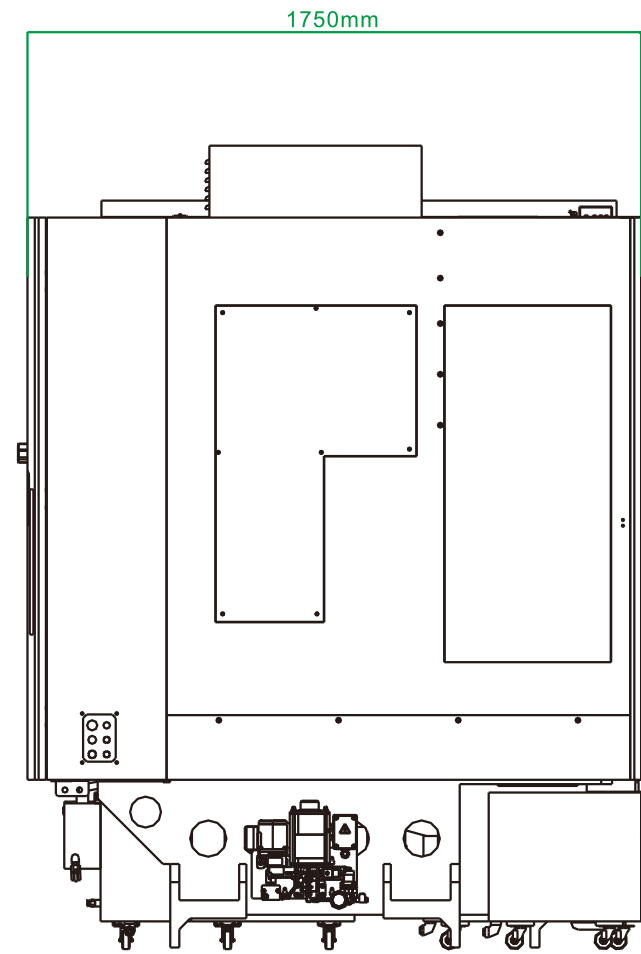

Left