

JTGK-600G

Speed Engraving and Milling CNC Machine

Product descriptions and features

■ Features

- New generation CNC controller
- Temperature control technology, long time precision stability
- The new structural design increases the machine rigidity, stable and reliable
- Favorable chip removal for different machining requirements
- Mature technology of vibration suppression, improve the tool life

■ For Material

Steel, stainless steel, copper, aluminum

■ Applied Range

Mold, electrode, parts, etc



KEJIE website



KEJIE wechat

Parameters

Item	Parameter
Working area X/Y/Z	600/500/300mm
Work table size	650x500mm
Max load of table	300kg
Spindle power Max spindle speed	6.8kw/24000rpm or 6.8kw/30000rpm
Rapid traverse rate	20m/min
Cutting feed rate	16m/min
Positioning accuracy	0.008mm
Repeatability	0.004mm
Weight	4500kg
Machine dimension	2210x2100x2420mm
Power supply	3-PH AC380V ±5% 50Hz

Standard Accessories

- High speed CNC controller
- Precision ball screw and guide rail
- AC servo motor
- High speed motorized spindle
- Automatic tool magazine
- Spindle cooling system
- Lubrication system
- Tool setting sensor

Optional Accessories

- Full closed-loop linear encoder
- 4th axis or 4.5th axis
- Oil mist collector
- Voltage stabilizer
- Probe
- Automatic chip removal device

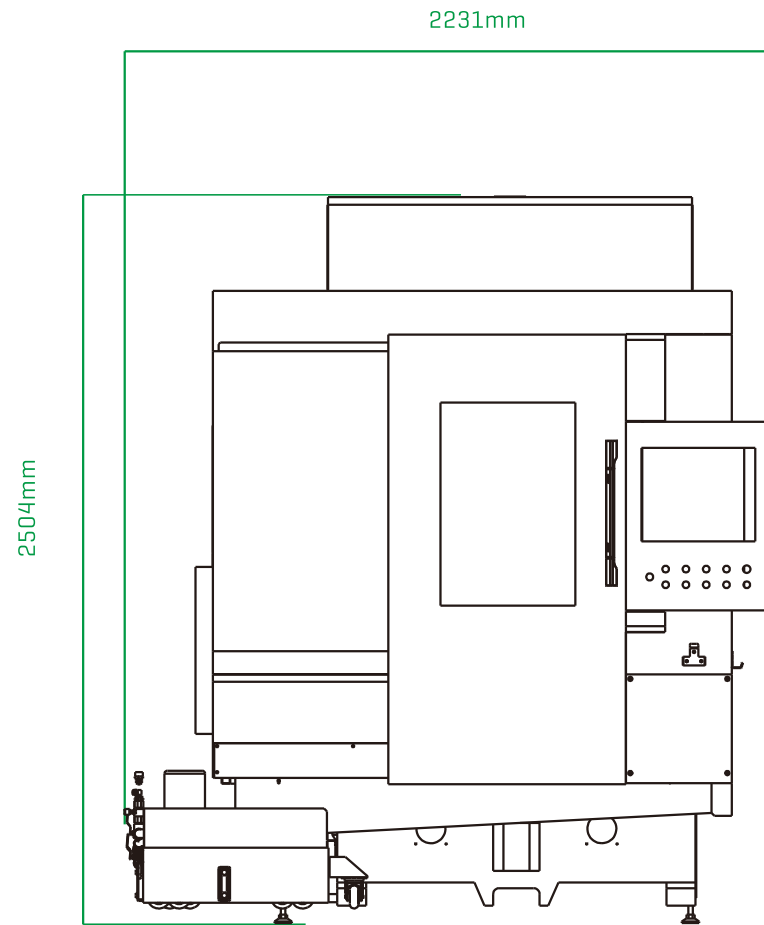

Front

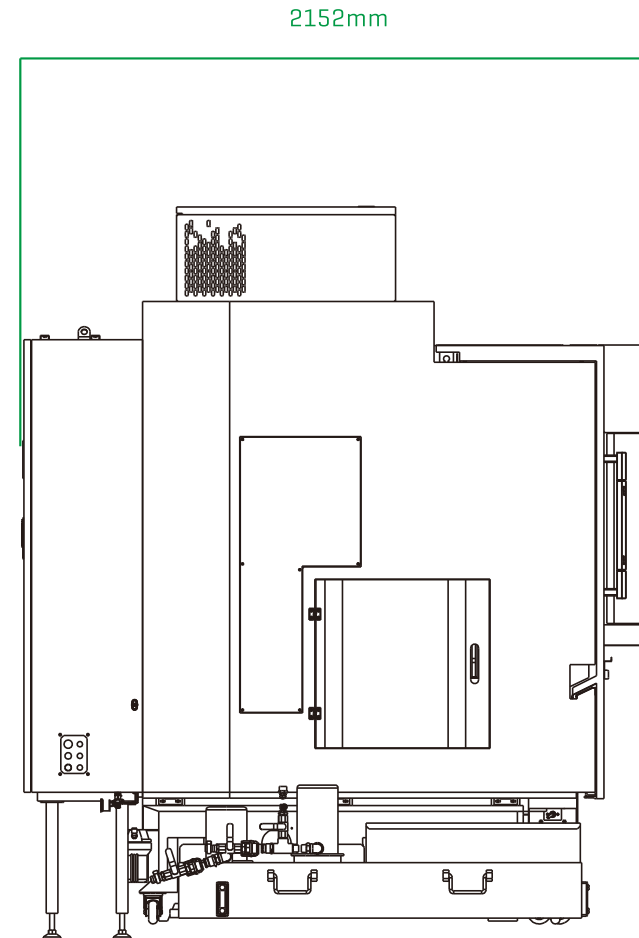

Left